

**FREE  
AIRFARE\***

**+ EARLY BIRD RATES**

WHEN BOOKED AND PAID IN  
FULL ONE YEAR PRIOR  
TO DEPARTURE\*\*



Emerald Kaia

*Main Street Tours featuring Emerald Luxury Yachts*

# Hidden Gems of the Croatian Riviera

Dubrovnik to Venice

September 25 - October 3, 2026



# Hidden Gems of the Croatian Riviera

**9-Days**

Dubrovnik to Venice

**Departing:** September 25, 2026

Experience the stunning beauty of Croatia's Adriatic Coast, on this 7-night cruise that set sails from the historic port city of Dubrovnik. On this memorable journey, visit ancient sites, architectural wonders and pretty beaches and coves. Marvel as you witness the splendour of Dubrovnik's Old Town, stroll up Marjan Hill for panoramic views of Split and discover Piran, the most picturesque town on the Slovenian coast. Your luxury cruise concludes in Italy and the 'City of Canals,' Venice, captivating visitors for centuries with its winding canals, romantic bridges, and refined Venetian culture.

Dubrovnik, Croatia



Enjoy the nightlife while docked in Split, Croatia



① Number of nights — Cruise ◆ Cruise start/finish

# Hidden Gems of the Croatian Riviera

## Day 1 Depart USA

Depart the USA on your overnight flight to Dubrovnik, Croatia. Please book your flight to arrive into Dubrovnik prior to 07:00 PM.

## Day 2 Dubrovnik, Croatia

Your Adriatic cruise begins in Croatia, in the dazzling city of Dubrovnik. Here, you will be transferred to your Emerald Cruises luxury yacht to embark on a voyage to discover historic towns and cities and extraordinary coastlines. **Meal: D**

## Day 3 Dubrovnik, Croatia

Known as the 'Pearl of the Adriatic,' Dubrovnik presents a compelling historic city along Croatia's Dalmatian Coast; its walled Old Town presents one of the finest examples of a medieval citadel in Europe. With its storied history and breathtaking views of iconic terracotta rooftops and the alluring Adriatic Sea, Dubrovnik offers the perfect blend of cultural exploration and a relaxing beach holiday. **Meals: B, L, D**

## Day 4 Split, Croatia

Croatia's second-largest city, Split, is visually stunning and laden with culture, history, and striking architecture. Take a stroll along the Riva, past beautiful terraces, palm trees and bustling eateries to enjoy gorgeous harbor views. Diocletian's Palace, built in the 4th century AD and today, a UNESCO World Heritage-listed site, dominates the city center and houses a myriad of buzzing bars and cafés. **Meals: B, L, D**

## Day 5 Split, Croatia – Zadar, Croatia

In the morning, get ready to set sail from Split to Zadar. A historic city set on a peninsula; Zadar boasts relics from a variety of eras. Explore the old churches, Roman ruins, and unique modern attractions, including the Sun Salutation and Sea Organ, which are innovative sound and sun-activated art pieces. **Meals: B, L, D**

## Day 6 Opatija, Croatia

On the western peninsula of Croatia, southwest of the city of Rijeka, Opatija provides alluring views across the Adriatic towards the Kvarner Islands and the distant Istrian Mountains. Known as the 'Nice of Croatia', Opatija reveals lovely seaside promenades and fairy-tale villas. While here, be sure to sample one of the famous local dishes, mussels with pršut or fish stew. **Meals: B, L, D**

## Day 7 Piran, Slovenia

Piran is a pretty town of red-tiled, whitewashed buildings clustered on the tip of the Slovenia's Piran peninsula. Part of the Venetian empire from the late 13th century to the end of the 18th century, Piran is esteemed for its gothic-style Venetian architecture. **Meals: B, L, D**

## Day 8 Venice, Italy

Today, you will arrive in Venice, truly an enchanting city that exudes an evocative atmosphere not found anywhere else in the world. Established in the 5th century, this romantic Italian city spans 118 small islands in the marshy Venetian Lagoon along the Adriatic Coast. Admire the grandeur of the iconic canals and magnificent St. Mark's Basilica. **Meals: B, L, D**

## Day 9 Venice, Italy

Your Emerald Cruises voyage concludes here. From your luxury yacht, you will be transferred to the airport for your journey home or to continue your holiday. Please book your flight to depart out of Venice after 11:00 AM. **Meal: B**



The canals of Venice, Italy

## Included in your cruise

- Airport transfers to and from your yacht
- 7 nights onboard the luxurious *Emerald Kaia*
- 20 meals: 7 breakfasts, 6 lunches and 7 dinners
- Complimentary wine, beer, soft drinks & selected cocktails throughout the day
- State-of-the-art coffee machines and tea stations
- Complimentary water, restocked daily
- First-class service from an English-speaking crew
- Included excursions with knowledgeable local guides
- Complimentary Wi-Fi
- Port charges
- All gratuities included

Itinerary subject to change

## 9-Day Hidden Gems of the Croatian Riviera

2026 Departure Date

Journey Code: E03D

Sep 25

CAT	Stateroom/Suite	Deck	Sep 25	
			Early Bird Per Person Twin From	Full Fare Per Person Twin From
D	Oceanview Stateroom	3	\$6,345	\$6,745
B	Balcony Suite	4	\$8,515	\$8,915
Y	Yacht Suite	4	\$12,610	\$13,010
A	Balcony Suite	5	\$8,830	\$9,230
T	Terrace Suite	5	\$11,910	\$12,310
AB	Balcony Suite	6	\$9,145	\$9,545
S	Deluxe Balcony Suite	6	\$10,055	\$10,455
SA	Owner's Suite	6	\$19,540	\$19,940

\*Reservation must be paid in full one year prior to departure to qualify for FREE Airfare, not valid on category D bookings. \*\*Early Bird rates are valid until one year prior to departure.

# Emerald Kaia

Launching: 2026 Length: 361ft Guests: 128 Suites: 64 Crew Members: 92

Deck 7  
Sky Deck

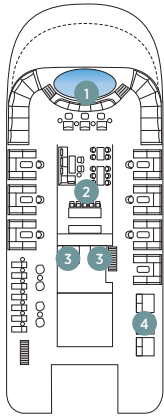

Deck 6  
Pool Deck

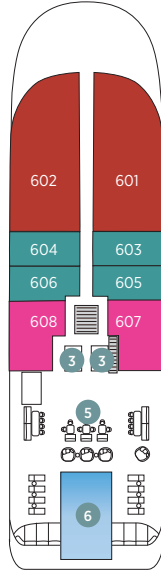

Deck 5  
Panorama Deck

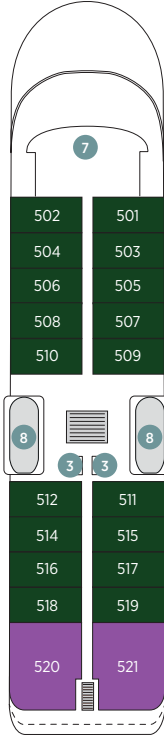

Deck 4  
Observation Deck

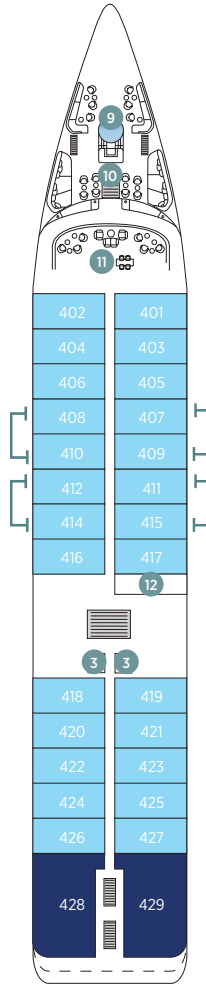

Deck 3  
Emerald Deck

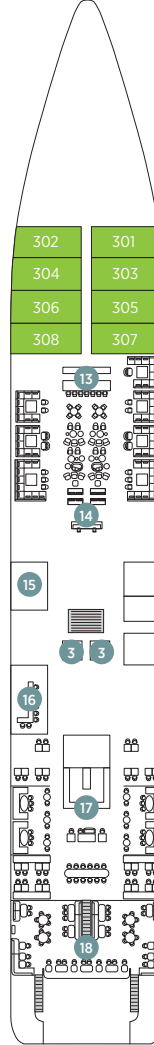

Deck 2  
Wellness Deck

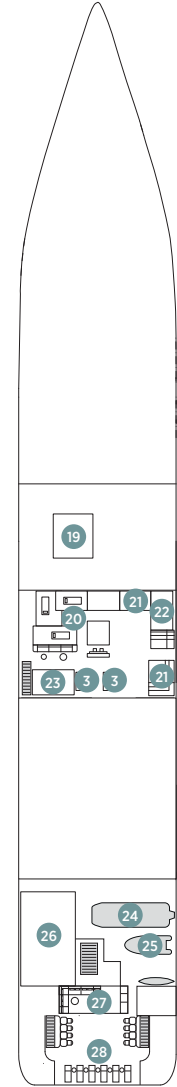

Pool Deck		Size (ft²)
SA	Owner's Suite	1,407ft²
S	Deluxe Balcony Suite	382ft² - 403ft²
AB	Balcony Suite	340ft²
Panorama Deck		Size (ft²)
T	Terrace Suite	830ft²
A	Balcony Suite	340ft²
Observation Deck		Size (ft²)
Y	Yacht Suite	879ft²
B	Balcony Suite	340ft²
Emerald Deck		Size (ft²)
D	Oceanview Stateroom	340ft²

**NEW for Emerald Kaia:**

Enjoy the luxury of even more generously-sized spaces with larger suites.

Suites 412 & 414, 411 & 415, 408 & 410, 407 & 409 can be booked to create connecting suites.

- 1 Spa Pool
- 2 Sky Bar
- 3 Lifts
- 4 Sky Deck Cabanas
- 5 Aqua Café
- 6 Aqua Pool
- 7 Navigation Bridge
- 8 Life Boats
- 9 Spa Pool
- 10 Observation Sun Deck
- 11 Observation Lounge
- 12 Self-Service Laundry
- 13 Amici Bar & Lounge
- 14 Reception
- 15 Boutique
- 16 Night Market Grill
- 17 La Cucina Dining
- 18 La Cucina Terrace
- 19 Medical Centre
- 20 Elements Spa
- 21 Sauna
- 22 Infrared Sauna
- 23 Hairdresser
- 24 Tender Boat
- 25 Zodiacs
- 26 Gym
- 27 Marina Lounge
- 28 Marina Deck

**Travelers Protection Plan (TPP)**

This nonrefundable fee will provide a refund to you during the instance that you have to cancel your trip. The cancellation has to be for a covered reason (see Plan for details on coverage) and we have to be notified at least one day prior to departure. If you must leave the tour early due to personal illness or the illness or death of an immediate family member, TPP will provide a refund for any unused services after the departure of the tour. Other benefits include medical expenses for illness and injury, emergency transportation, 24 hour hot line and lost or stolen baggage assistance. Return air transportation is included ONLY if your air tickets are purchased through Mayflower Cruises & Tours. Please review the Plan for details on coverage.

Should you choose not to purchase our TPP, the following per person cancellation charges will be assessed for all tours and optional excursion costs:

- 121 days or more prior to departure: Deposit Amount
- 120 days until day of departure: 100% of total tour
- No refund on unused portions of the tour

**Exclusions for the Cancellation Fee Waiver:** Mayflower Cruises & Tours reserves the right to alter its Refund and Cancellation Policy when a substantial amount of cancellation or postponement of travel is attributable to: conditions resulting from an act of God, natural or man-made disaster, fire, government action, civil disorder, war, hostilities between nations, or unavailability of transportation through no fault of Mayflower Cruises & Tours.



**Passport & Visas** – Each U.S. citizen must have a valid passport. Expiry date of passports should be at least 6 months after the return date of tour. If you don't have a passport, call our office and we'll tell you how to apply for one. Some countries require visas for entry by U.S. citizens. We will send visa applications and instructions if a visa is required for your tour. Holders of non-U.S. passports should contact their nearest consulate and inquire about the necessary passport or visa documentation required for entry into the countries visited. NOTE: Due to airline security measures, your passport name must match your airline ticket name and your tour reservation name or you may be denied aircraft boarding.

FOR RESERVATIONS OR INFORMATION CONTACT:

**MAIN STREET TOURS**  
**(800) 300-6246**

E-Mail: [Laurie@mainstreettours.com](mailto:Laurie@mainstreettours.com)

4010 Watson Plaza Drive, Suite 139  
Lakewood, CA 90712





**4010 Watson Plaza Drive  
Suite 139  
Lakewood, CA 90712  
800.300.6246**

www.mainstreettours.com

California Registered  
Seller of Travel #10114358-40

# HIDDEN GEMS OF THE CROATIAN RIVIERA

## SEPTEMBER 25 - OCTOBER 3, 2026

### RESERVATION FORM

Please complete one form per person

**PRICES INCLUDE  
FREE ROUNDTRIP AIRFARE FROM LAX or SFO  
IF FULL PAYMENT IS RECEIVED BY SEPTEMBER 25, 2025**

- I plan to pay in full by September 25, 2025, to qualify for the FREE AIRFARE and discounted cruise price
- I will not be paying in full by September 25, 2025, and would like the air added at a cost of \$1,900
- I would like to fly out of  Los Angeles (LAX)  San Francisco (SFO)
- I plan to take care of booking my own air and will meet the group in Dubrovnik

**Full Name (as it appears on your passport):** \_\_\_\_\_

- I will be sharing a room with: \_\_\_\_\_
- I prefer to travel single occupancy and will pay the single rate

Mailing Address: \_\_\_\_\_  
 City \_\_\_\_\_ State: \_\_\_\_\_ Zip: \_\_\_\_\_  
 Phone: Home \_\_\_\_\_ Cell \_\_\_\_\_  
 Birthdate: \_\_\_\_/\_\_\_\_/\_\_\_\_ Place of Birth: \_\_\_\_\_ Gender:  M  F  
 Passport Number: \_\_\_\_\_ Date of Issue: \_\_\_\_\_ Expiration Date: \_\_\_\_\_  
 Passport Issue City, State, Country: \_\_\_\_\_ Citizenship: \_\_\_\_\_  
 Known Traveler Number - TSA Pre or Global Entry (if applicable): \_\_\_\_\_  
 E-Mail: \_\_\_\_\_  
 Emergency Contact Name: \_\_\_\_\_  
 Relationship: \_\_\_\_\_ Phone: \_\_\_\_\_  
 Special needs/requests: \_\_\_\_\_

***If paying by cash or check (make checks payable to Main Street Tours):***

Amount of Deposit Enclosed: \$ \_\_\_\_\_ Check No. \_\_\_\_\_

***If paying by credit card: Visa or Mastercard (sorry, the cruise line does not accept American Express)***

Credit Card No.: \_\_\_\_\_  
 Expires: \_\_\_\_ / \_\_\_\_ 3-digit Security Code: \_\_\_\_\_ Amount to be Charged: \_\_\_\_\_  
 Name as it appears on credit card: \_\_\_\_\_

**I have read and understand the cancellation and refund policy for this tour, as well as the current Booking Agreement Terms and Conditions.**

\_\_\_\_\_  
 Signature (required) Date: \_\_\_\_\_

**PRICES INCLUDE ROUNDTRIP AIRFARE FROM LAX IF FULL PAYMENT IS RECEIVED BY SEPTEMBER 25, 2025.  
Otherwise, the cost of the roundtrip airfare is an additional \$1,900 per person**

**PREFERRED CABIN CATEGORY: 1st Choice \_\_\_\_\_ 2nd Choice \_\_\_\_\_ 3rd Choice \_\_\_\_\_**

			<b>PAY IN FULL BY 9/25/2025 includes free roundtrip airfare</b>	<b>REGULAR FARE plus \$1,900 for air</b>
<b>Category D</b>	Oceanview Stateroom Deck 3	<input type="checkbox"/> Double occupancy: <input type="checkbox"/> Single occupancy:	\$6,345 per person* Call for single rates	\$6,745 per person* Call for single rates
<b>Category B</b>	Balcony Suite Deck 4	<input type="checkbox"/> Double occupancy: <input type="checkbox"/> Single occupancy:	\$8,515 per person Call for single rates	\$8,915 per person Call for single rates
<b>Category A</b>	Balcony Suite Deck 5	<input type="checkbox"/> Double occupancy: <input type="checkbox"/> Single occupancy:	\$8,830 per person Call for single rates	\$9,230 per person Call for single rates
<b>Category S</b>	Deluxe Balcony Suite Deck 6	<input type="checkbox"/> Double occupancy: Single occupancy:	\$10,055 per person N/A	\$10,445 per person N/A
<b>Category T</b>	Terrace Suite Deck 5	<input type="checkbox"/> Double occupancy: Single occupancy:	\$11,910 per person N/A	\$12,310 per person N/A
<b>Category Y</b>	Yacht Suite Deck 4	<input type="checkbox"/> Double occupancy: Single occupancy:	\$12,610 per person N/A	\$13,010 per person N/A
<b>Category SA</b>	Owner's Suite Deck 6	<input type="checkbox"/> Double occupancy: Single occupancy:	\$19,540 per person N/A	\$19,940 per person N/A

\* Free Airfare is not valid on Category D bookings.

NOTE: Space is subject to availability at time of booking and deposit. All cabins are assigned on a first come, first served basis.

**TRAVEL PROTECTION PLAN (TPP) - you MUST check one:**

- Please add the Travelers Protection Plan (TPP) - **must be purchased at time of deposit**
- I am declining the optional Travel Protection Plan

Cost of Travel Protection Plan (TPP) is based on the price of your cruise package:

\$5,000-\$7,500	TPP is \$499 per person
\$7,501-\$9,999	TPP is \$599 per person
\$10,001-\$12,000	TPP is \$799 per person
\$12,001-15,000	TPP is \$999 per person
\$15,001-\$17,000	TPP is \$1,199 per person
\$17,001-\$20,000	TPP is \$1,299 per person

**DEPOSIT (per person)**

<input type="checkbox"/>	<b>Without TPP</b>	<b>\$ 500</b>
<input type="checkbox"/>	<b>With TPP Coverage - Total package price from \$5,000-\$7,500</b>	<b>\$ 999</b> (\$500 deposit + \$499 TPP)
<input type="checkbox"/>	<b>With TPP Coverage - Total package price from \$7,501-\$9,999</b>	<b>\$1,099</b> (\$500 deposit + \$599 TPP)
<input type="checkbox"/>	<b>With TPP Coverage - Total package price from \$10,000-\$12,000</b>	<b>\$1,299</b> (\$500 deposit + \$799 TPP)
<input type="checkbox"/>	<b>With TPP Coverage - Total package price from \$12,001-\$15,000</b>	<b>\$1,499</b> (\$500 deposit + \$999 TPP)
<input type="checkbox"/>	<b>With TPP Coverage - Total package price from \$15,001-\$17,000</b>	<b>\$1,699</b> (\$500 deposit + \$1,199 TPP)
<input type="checkbox"/>	<b>With TPP Coverage - Total package price from \$17,001-\$20,000</b>	<b>\$1,799</b> (\$500 deposit + \$1,299 TPP)

**WE REQUIRE A COPY OF YOUR PASSPORT WITHIN TWO WEEKS OF BOOKING.**

**Please make sure your passport does not expire before April 3, 2027.**

**Passports must be valid for at least six months past your travel dates.**

**FINAL PAYMENT**

For the FREE AIRFARE offer, final payment must be received by September 25, 2025.

If not paying in full by September 25, 2025, final payment is due by May 25, 2026.

**CANCELLATION AND REFUND POLICY:**

Cancel prior to May 25, 2026

Guest forfeits their deposit UNLESS the Travel Protection Plan was purchased at time of deposit and you are cancelling for a covered reason.

Cancel on or after May 25, 2026

No refunds UNLESS the Travel Protection Plan was purchased and you are cancelling for a covered reason.

# CABIN OPTIONS



## CATEGORY SA - Owner's Suite

Suite size: 1407 sq. ft. (includes outside terrace)  
Location: Deck 6

The two oversized Owner's Suites are the largest and most opulent, located on the Pool Deck. Boasting a separate bedroom and lounge area, you'll also enjoy your large private terrace, from which to admire the stunning views of each port you visit.

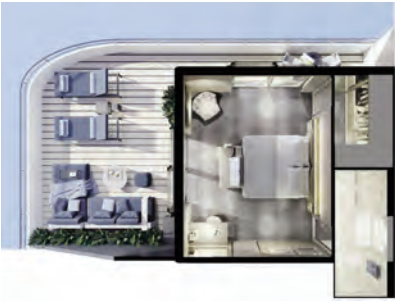

## CATEGORY Y - Yacht Suite

Suite size: 879 sq. ft. (includes outside terrace)  
Location: Deck 4

Positioned at the back of the Observation Deck, you'll be treated to sensational ocean and coastal views from your own private terrace. You'll also receive a number of luxury inclusions to help you make the most of your time in your Yacht Suite.



## CATEGORY T - Terrace Suite

Suite size: 830 sq. ft. (includes outside terrace)  
Location: Deck 5

Spacious Terrace Suites take pride of place at the back of the Panorama Deck. As the name suggests, you'll enjoy a private oversized terrace, where you'll be able to relax and take in the views as you sail into the world's prettiest ports.



## CATEGORY S - Deluxe Balcony Suite

Suite size: 382-403 sq. ft.  
Location: Deck 6

Deluxe Balcony Suites are conveniently located on the Pool Deck and feature their own private balcony. With just two per yacht, you'll benefit from having extra space for your assured comfort.



## CATEGORY A and B - Balcony Suite

Suite size: 340 sq. ft.  
Location: Decks 5 & 4

Divided between the Observation and Panorama decks, Balcony Suites are your stylish home-away-from-home. With everything you need for a great night's sleep, we've carefully designed them to help you relax after a day of exploration.



## CATEGORY D - Oceanview Stateroom

Suite size: 540 sq. ft.  
Location: Deck 3

Situated on the Emerald Deck, towards the front of the yacht, Oceanview Staterooms are bigger than the average standard, offering excellent value for money.

**EMERALD KAIA**  
**TECHNICAL DATA**  
Launch Date: 2026  
Length 361 ft (110m)  
Guests 128  
Cabins 64  
Crew 92

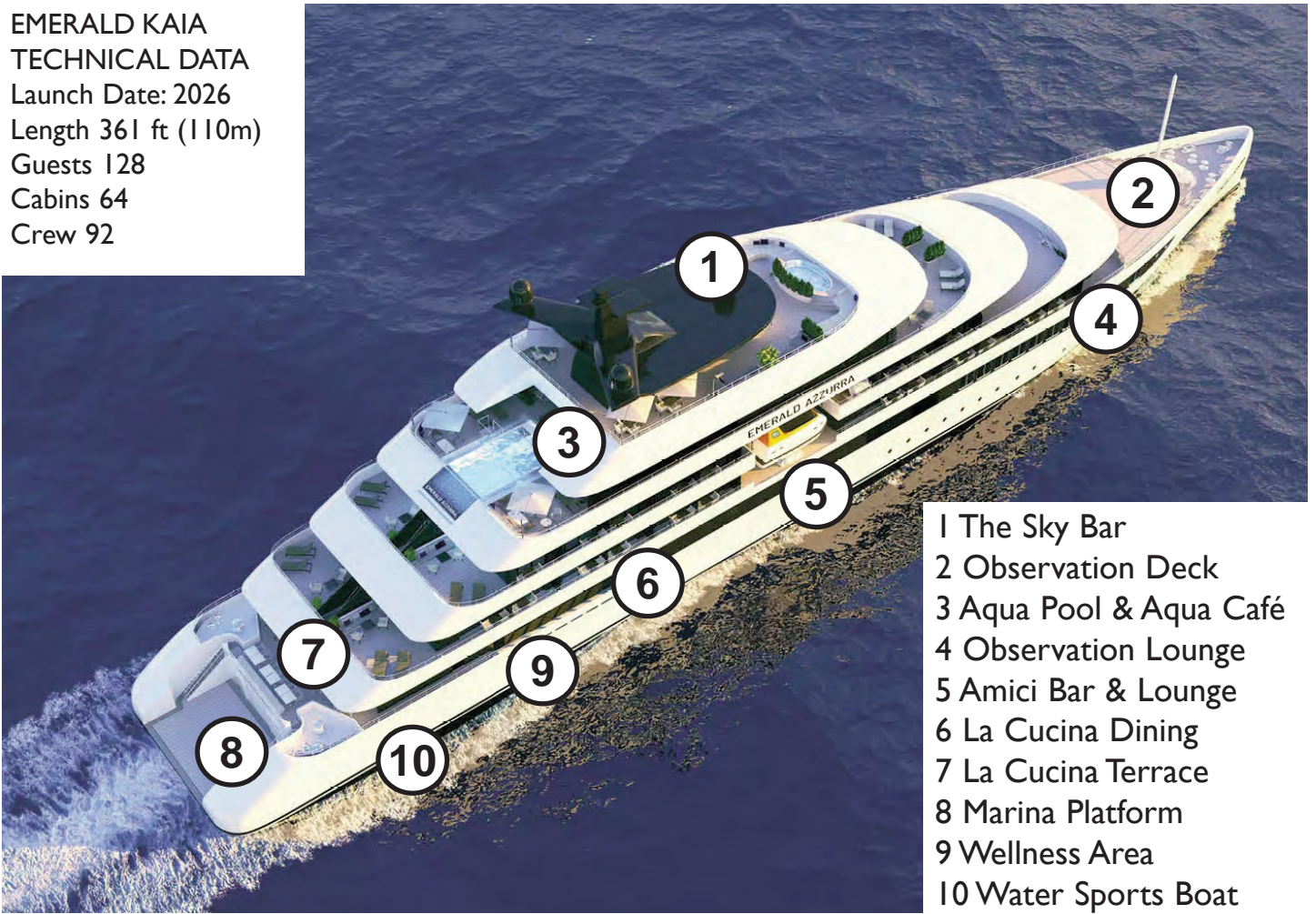

- 1 The Sky Bar
- 2 Observation Deck
- 3 Aqua Pool & Aqua Café
- 4 Observation Lounge
- 5 Amici Bar & Lounge
- 6 La Cucina Dining
- 7 La Cucina Terrace
- 8 Marina Platform
- 9 Wellness Area
- 10 Water Sports Boat

